

# ***BT Contour 200***

## ***User guide***



# Contents

## Everyday features

### *Making and answering calls*

- Making a normal payphone call .....4
  - To call a pre-programmed memory number .....5
  - To make another call .....5
  - To redial the last number you dialled . .5
  - Making a call using a Memory button .5

- Making an Owner call using your PIN ....6

- Making an Owner call using your cash box key .....6

- Answering calls .....7

### *Money*

- Emptying the cash box .....8

- Checking the total money taken using your PIN .....9

- Checking the total money taken using the cash box key .....9

## Extra features

- How to get started .....11

### *Barring*

- Barring certain outgoing calls .....12

- Barring calls made with fake coins or tokens .....13

- Barring incoming calls .....14

- Setting the ringer switch .....15

- Barring old coins from being used .....16

### *Call handling*

- Withholding your number .....17

- Setting the identification tone .....18

- Setting the Operator tone .....19

- Setting the privacy feature .....20

- Setting an automatic switchboard code .21

- Setting a manual switchboard code ....22

- Removing a switchboard code .....23

### *Charging*

- Setting call charges .....24

- Setting the minimum fee .....25

- Programming new coins or tokens .....26

- Programming exception codes .....27

- Cancelling exception codes .....28

- Charging for calls to Directory Enquiries 28

### *Payphone settings*

- Programming the Memory buttons ....30

- Setting the payment timer .....29

- Setting the time and day .....32

- Using different display languages .....33

- Changing your PIN .....34

- Setting the dialling mode .....34

## Troubleshooting .....35

## Technical information .....38

## Index .....39

## Important information

**Make a note of your BT Contour 200 Payphone serial number** which is printed on the bottom of your phone

**Your cash box key number**

If you need any help, please visit our website at [www.bt.com/payphones](http://www.bt.com/payphones)

If you need to contact us, please send an email with your query to [product.help.payphones@bt.com](mailto:product.help.payphones@bt.com) or call the **Payphone Helpdesk** free on **0800 25 25 41** and we will be pleased to help you. Lines are open Monday to Saturday, 8am to 6pm.

If you need replacement cash box keys, please call the **X2Connect Ltd Helpdesk** free on **0800 373 085**.

If you would like to speak to our Sales Team, please call the **Payphone Sales Desk** free on **0800 11 55 11**. Lines are open Monday to Friday, 8am to 6pm and Saturday from 9am to 2pm.

# *Everyday features*

These are the most common features and functions, which you will probably use most often. For any other features, see the *Extra features* section on page 10.

## **Making and answering calls**

▶ page 4

These instructions will tell you how to use the payphone for making and answering normal calls, and for making Owner calls.

If you want to make an Owner call – where you don't have to put in any cash and the calls you make are charged to your normal phone bill – you will find the instructions on page 6.

## **Money**

▶ page 8

These instructions will tell you how to empty the cash box, find out the amount of money the payphone has taken, and reset the counter to £0.00.

## Making a normal payphone call

**Before you make a normal payphone call**, make sure you have enough cash ready. Put in the money as soon as your call is answered or the call will be disconnected.

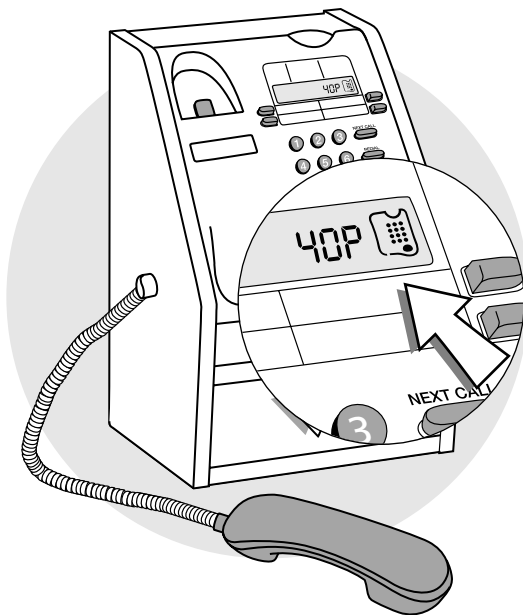

- 1** Lift the handset  
*The display will show PLEASE DIAL*
- 2** Dial the number  
*The display will show the number as you dial it.*
- 3** Wait for your call to be answered
- 4** As soon as your call is answered, put your money in  
*You will need to insert coins to at least the value shown on the display. The payphone uses the code dialled and the time and day to calculate the minimum fee.*  
*The payphone will accept 10p, 20p, 50p and £1 coins, and any other coins or tokens you program it to accept (see page 26 for instructions).*
- 5** As you talk, keep an eye on the display  
*The display will show how much money you have left. 20 seconds before the money runs out, the display will flash and you will hear a series of beeps. You can add more money at any time during the call, but remember that the payphone does not return any unused coins.*

To call a pre-programmed memory number, you will need to lift the handset and press the appropriate Memory button. Wait for your call to be answered. As soon as your call is answered, put your money in.

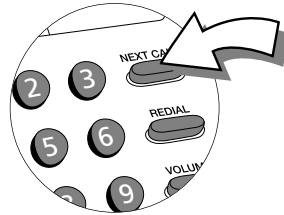

---

To make another call with your remaining money, don't hang up

- Press **NEXT CALL**
- Dial the number  
*If you dial the number incorrectly, press **NEXT CALL** and dial the number again.*
- Wait for your call to be answered
- Press \* to speak.

---

To redial the last number you dialled, don't hang up

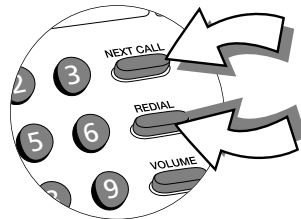

- Press **NEXT CALL** when you hear the engaged tone
- Press **REDIAL**

This feature can be activated by following the instructions and using either your PIN or the programming key.

It is best to use your PIN for the features where you have a choice of methods, as it is easier and more secure.

## Making an Owner call using your PIN

- 1 Lift the handset
- 2 Press \*  
*The display will show PIN*
- 3 Enter your PIN
- 4 Press **NEXT CALL**  
*The display will show OWNER CALL*
- 5 Dial the number – you do not need to put any money in when your call is answered
- 6 To make another call, don't hang up
  - Press **NEXT CALL**
  - Dial the number*When you have finished your calls, hang up. The payphone will then be ready to make normal payphone calls.*

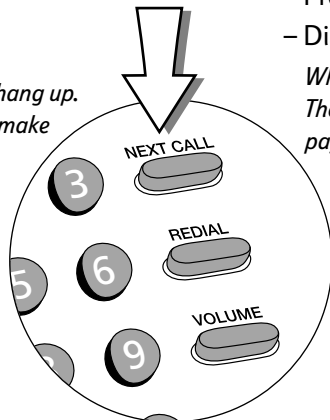

## Making an Owner call using your programming key

- 1 Lift the handset
- 2 Unlock the programming lock and leave the key in the lock
- 3 Press **NEXT CALL**
- 4 Lock the programming lock and remove the key  
*The display will show OWNER CALL*
- 5 Dial the number – you do not need to put any money in when your call is answered
- 6 To make another call, don't hang up
  - Press **NEXT CALL**
  - Dial the number*When you have finished your calls, hang up. The payphone will then be ready to make normal payphone calls.*

## Answering calls

When your payphone rings, you just need to lift the handset to answer the call. The caller will hear a series of beeps which will let them know they are calling a payphone.



## Emptying the cash box

---

You will need the cash box key

---

- 1** Unlock the cash box and pull it out. You can pull it out partway or take it out completely.
  - 2** Empty the cash box
  - 3** Replace the cash box and lock the cash box lock.
- 

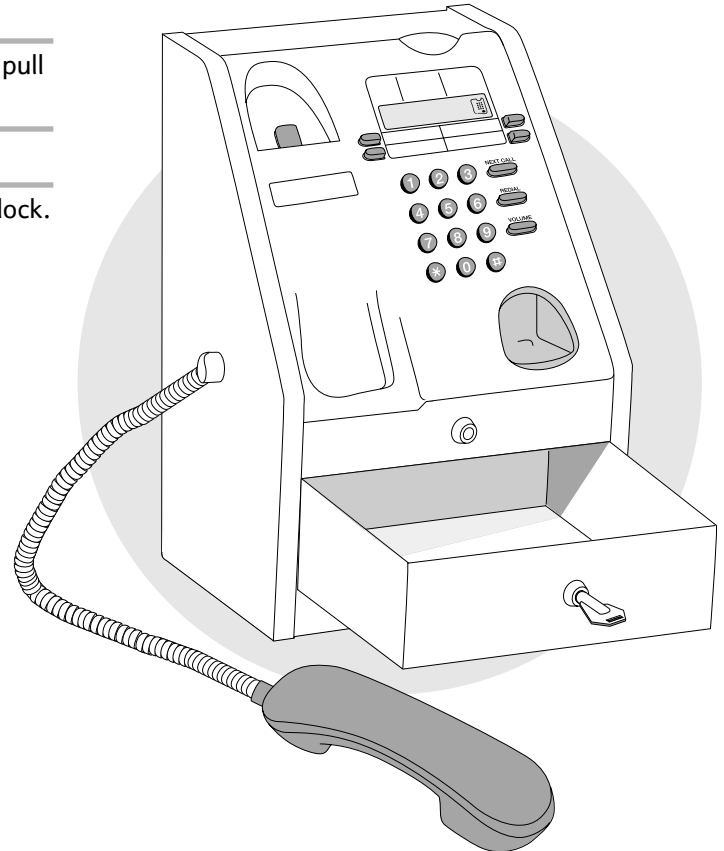



## Checking the total money taken using your PIN

- 1 Lift the handset
- 2 Press \*  
*The display will show PIN*
- 3 Enter your PIN
- 4 Press \*66  
*The display will show MONEY*
- 5 Press # to see how much money the payphone has taken since it was last reset
- 6 Press # again to see how much money the payphone has taken since it was first used.

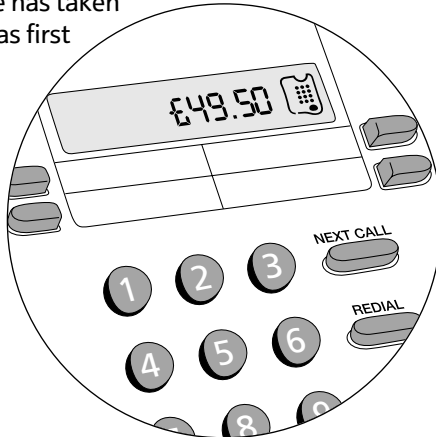

## Checking the total money taken using the programming key

- You will need the programming key
- 1 Lift the handset
  - 2 Unlock the programming lock and leave the key in the lock
  - 3 Press \*66  
*The display will show MONEY*  
*If it does not, hang up, lift the handset and try entering \*66 again.*
  - 4 Press # to see how much money the payphone has taken since it was last reset.

**After the last step of either method, you can reset the amount to £0.00**

Press 0, then #.

*The display will flash once to confirm that you have reset it to £0.00.*

This feature can be activated by following the instructions and using either your PIN or the programming key.

It is best to use your PIN for the features where you have a choice of methods, as it is easier and more secure.

# *Extra features*

You can use these features to personalise your BT Contour 200 Payphone for your precise needs.

<i>Type of feature</i>	<i>Features</i>	<i>Page</i>
Barring	Barring certain outgoing calls	12
	Barring calls made with fake coins or tokens	13
	Barring incoming calls	14
	Setting the ringer switch	15
	Barring old coins from being used	16
Call handling	Withholding your number	17
	Setting the identification tone	18
	Setting the Operator tone	19
	Setting the privacy feature	20
	Setting an automatic switchboard code	21
	Setting a manual switchboard code	22
Removing a switchboard code	23	
Charging	Setting call charges	24
	Setting the minimum fee	25
	Programming new coins or tokens	26
	Programming exception codes	27
	Cancelling exception codes	28
	Charging for calls to Directory Enquiries	28
Payphone settings	Setting the payment timer	29
	Programming the Memory buttons	30
	Setting the time and day	32
	Using different display languages	33
	Changing your PIN	34
Setting the dialling mode	34	

# How to get started

You will need to use these instructions to start the programming mode when you want to change any of the extra features. Once you have started the programming mode, you can change as many features as you like as long as you don't hang up. If you hang up before you have finished programming, you will find a diagram to remind you how to start the programming mode in the left margin of every other page.

---

You will need the programming key

---

- 1 Lift the handset

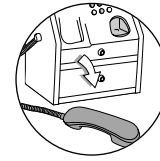

- 2 Unlock the programming lock and leave the key in the lock

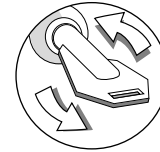

The display will show **PIN**

---

- 3 Enter your **PIN**

- 4 Press 

The display will show **MONEY**

If it still shows **PIN**  
the PIN was incorrect

– try entering it again. If you enter the wrong PIN more than once, contact the Helpdesk. For contact details, see page 2.

- 5 Choose the feature you want to program and follow the instructions on the following pages.

## Barring certain outgoing calls

### 1 Start programming

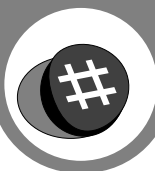

You can choose to prevent calls being made from your payphone to certain types of numbers.

*If a new phone code is launched and your payphone shows **BARRED** when you dial the new code, it is because the payphone does not recognise the code. You will need to program the new code as an exception code, using the instructions on page 27.*

*If the payphone says a number is barred when it shouldn't be, contact the Helpdesk. For contact details, see page 2.*

For information about the types of calls you can bar and the settings on your payphone when you first get it, see the table on the right.

### 1 Start programming, if you haven't already

#### 2 Press \*22#

*The display will show **FREE** ✓*

3 Press **Memory 1** to choose the type of call you want to bar or allow, and keep pressing it to scroll through the choices

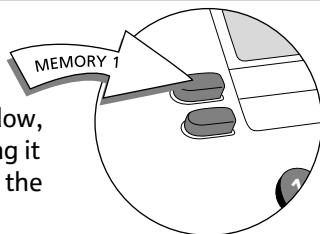

#### 4 Press **Memory 3** to bar or allow calls

*The display will show the call type and whether it is barred or unbarred, e.g. **PREMIUM** ✓ to confirm the setting you have chosen*

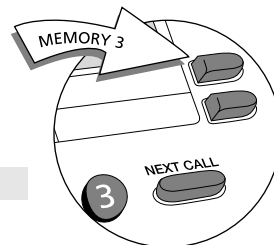

#### 5 Press **#**

*The display will flash once to confirm the barred and unbarred numbers have been set.*

#### 6 Repeat steps 3 and 4 until you have finished

#### 7 Program another feature or lock the cash box, remove the key and replace the handset.

## Barring calls made with fake coins or tokens

If you're having a problem with people using fake coins or tokens, known as slugs, you can program your payphone to reject them.

Call type	barred $\times$ unbarred $\checkmark$	types of calls barred
FREE	$\checkmark$	Calls that are normally free, eg 0800 and 0500 numbers
OPERATOR	$\times$	Calls to the Operator on 100 and 151
DIR ENQ	$\checkmark$	Calls to Directory Enquiries on 192 or 153
WORLD	$\checkmark$	Calls to any other countries
ASIA	$\checkmark$	Calls to Australia, New Zealand, Singapore and Hong Kong
AMERICA	$\checkmark$	Calls to America, Canada and the Caribbean
EUROPE	$\checkmark$	Calls to Europe
EIRE	$\checkmark$	Calls to the Republic of Ireland on numbers beginning with 00353
PREMIUM	$\times$	Calls to information services, eg numbers beginning with 090
MOBILE	$\checkmark$	Calls to mobile phones
NATIONAL	$\checkmark$	Calls outside your local area, eg numbers beginning with 01 and 02
LOCAL	$\checkmark$	Calls to local phone numbers and local rate numbers, eg numbers beginning with 2 to 9, and 0845 numbers

① Start programming, if you haven't already

2 Press  $\star 8 6 \#$

The display will show `TOKEN R 1`

3 Press  $\# \#$

The display will show `SLUG`

4 Insert the slug 8 times

The display will show `SLUG OK`

5 Program another feature or lock the programming lock, remove the key and replace the handset.

## Barring incoming calls

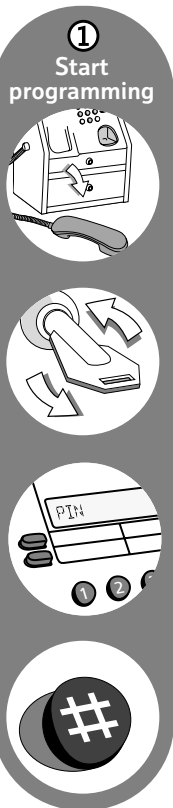

You can stop your payphone accepting any incoming calls.

① Start programming, if you haven't already

2 Press \*46#

The display will show ANSWER x

if incoming calls are barred,

or ANSWER ✓

if incoming calls are allowed.

3 Press **Memory 3**  
to change the setting

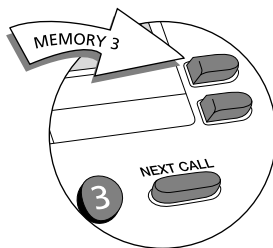

4 Press #

The display will show SET RINGER SWITCH ON

if incoming calls are allowed

or SET RINGER SWITCH OFF

if incoming calls are barred.

5 If you have barred incoming calls, switch the ringer volume to **Off** – see next page for details

*If you leave the ringer volume on High or Low, the payphone will ring every time someone calls, even if you have barred incoming calls, but you will not be able to answer.*

6 Program another feature or lock the programming lock, remove the key and replace the handset.

## Setting the ringer switch

You can switch the ringer off or switch the volume between high and low.

---

You will need the programming key

---

- 1** Unlock the cash box and lift the cover
  - 2** Switch the ringer to the volume you want – you can choose high, low or off
  - 3** Close the cover and lock the cash box.
- 

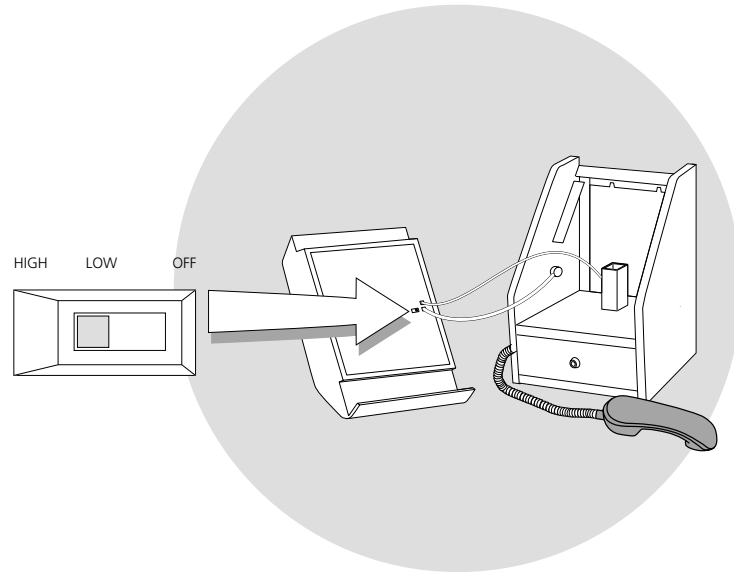

## Barring old coins from being used

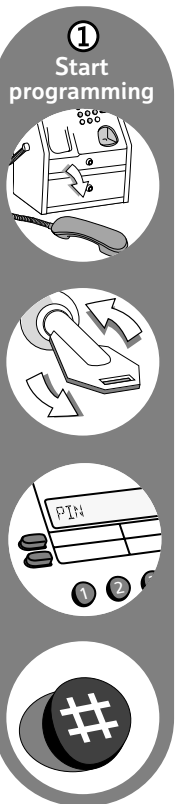

You can stop a coin from being used to make calls, for instance if the design changes or it is withdrawn from circulation.

① Start programming, if you haven't already

2 Press \*26#

The display will show **COIN 10P ✓**  
to show that 10p coins are allowed.

3 Press **Memory 1**  
to choose the coin  
you want to bar

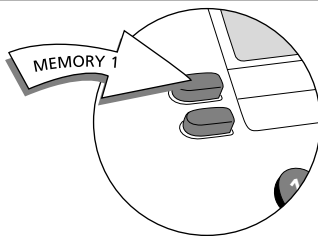

4 Press **Memory 3**  
to stop the coin  
being used

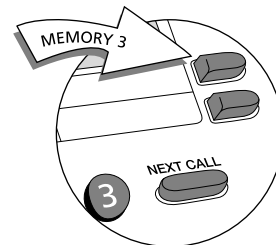

The display will show **COIN 10P x**  
to show that the coin is barred.

5 Press #

The display will flash once to confirm the coin has  
been barred.

6 Repeat steps 3 to 5 until you have finished

7 Program another feature or lock the cash box,  
remove the key and replace the handset.



## Withholding your number

If your payphone is not on a payphone line, it may display your number to people you are calling.

You can withhold your number to stop it from being available for people to call the payphone back.

**This service is not available on payphone lines.**

---

① Start programming, if you haven't already

---

2 Press \*23#

The display will show **WITHELD ✓**

if your number is withheld

or

**WITHELD x**

if your number is not withheld.

---

3 Press **Memory 3**  
to change the setting

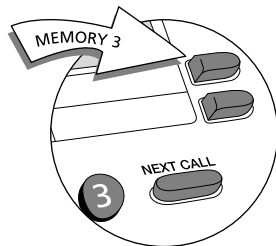

---

4 Press #

The display will flash once to confirm this service is set.

---

5 Program another feature or lock the programming lock, remove the key and replace the handset.

## Setting the identification tone

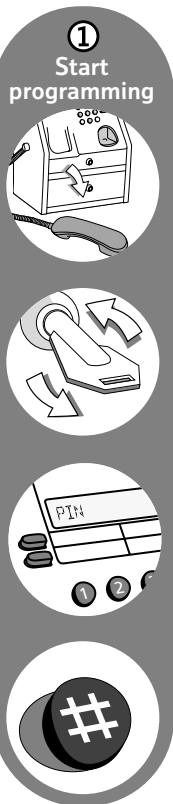

Callers to your payphone will hear a tone to tell them that they are calling a payphone. BT Operators will recognise this tone and will not connect reverse charge calls. You can choose to turn this tone off, although BT recommend that you leave it on.

① Start programming, if you haven't already

2 Press \*43#

The display will show `PID TONE ✓`

if the tone is on

or

`PID TONE x`

if the tone is off.

3 Press **Memory 3** to change the setting

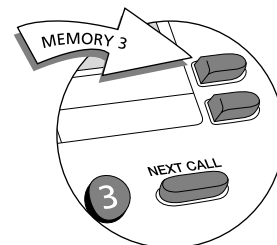

4 Press #

The display will flash once to confirm the setting has been changed.

5 Program another feature or lock the programming lock, remove the key and replace the handset.

## Setting the Operator tone

When anyone dials 100 from the payphone, the Operator will hear a tone which tells them that the call is from a payphone so they won't directly connect or transfer calls for the caller. You can choose to turn this tone off, although BT recommend that you leave it on.

① Start programming, if you haven't already

2 Press \*67#

The display will show `OP TONE ✓`

if the tone is on

or

`OP TONE x`

if the tone is off.

3 Press **Memory 3** to change the setting

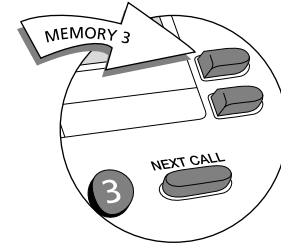

4 Press #

The display will flash once to confirm the Operator tone has been changed.

5 Program another feature or lock the programming lock, remove the key and replace the handset.

## Setting the privacy feature

①  
Start programming



If you have another phone connected to the same line as your payphone, you can transfer calls between them, but this also means that it's possible for calls made on one phone to be overheard on the other.

If you don't want to transfer calls and you would prefer that people can't overhear calls on the payphone, switch the privacy feature on. The default setting for the privacy feature is off.

*If you want to transfer calls to the payphone, make sure the payphone handset is lifted before you put down the handset on the other phone.*

① Start programming, if you haven't already

2 Press \*77#

The display will show PRIVATE ✓

if privacy is on

or

PRIVATE x

if privacy is off.

3 Press Memory 3 to change the setting

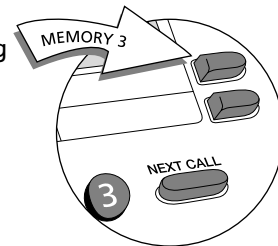

4 Press #

The display will flash once to confirm the privacy feature is set.

5 Program another feature or lock the programming lock, remove the key and replace the handset.

## Setting an automatic switchboard code

If your payphone is connected to an internal switchboard, you can choose whether the payphone will dial an access code such as 9 for an outside line, or whether callers will have to dial it themselves.

*If callers have to manually dial a code between 2 and 9 for an outside line, the payphone will charge the call at local rates. For more information, contact the Helpdesk. For contact details, see page 2.*

---

① Start programming, if you haven't already

---

2 Press \*72#

The display will show PBX CODE --

---

3 Enter the code

---

4 Press #

The display will show AUTOMATIC

---

5 Press #

The display will show PAUSE 3.5

*This is the length of time the payphone waits to get an outside line before it dials the phone number.*

---

6 To change the length of the pause, you can

- increase the pause by pressing **Memory 3**
- decrease the pause by pressing **Memory 4**.

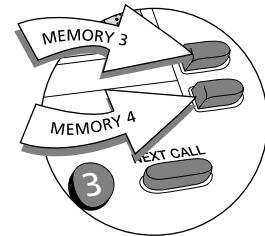

---

7 Press #

The display will show PBX CODE

and the code number

you programmed to confirm your choice.

---

8 Program another feature or lock the programming lock, remove the key and replace the handset.

## Setting a manual switchboard code

①  
Start programming

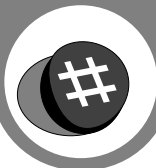

① Start programming, if you haven't already

2 Press \*72#

The display will show PBX CODE --

3 Enter the code

4 Press #

The display will show AUTOMATIC

5 Press Memory 1

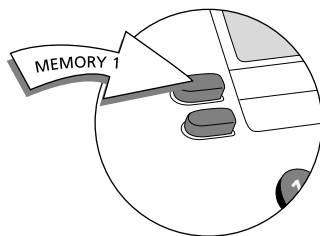

The display will show USER KEYED

6 Press #

The display will show EXTENSION -

7 Press the first digit of your extension numbers

This will tell the payphone which extensions it may call.

8 Press #

The display will show PBX CODE  
with the code number  
you programmed to confirm your choice.

9 Program another feature or lock the programming lock, remove the key and replace the handset.

## Removing a switchboard code

---

① Start programming, if you haven't already

---

2 Press \*72#

*The display will show  
with the number you  
programmed.*

PBX CODE

---

3 Press REDIAL

*The display will show*

PBX CODE --

---

4 Press #

*The display will show*

PBX

---

5 Program another feature or lock the programming lock, remove the key and replace the handset.

## Setting call charges

You can choose which rate your payphone will charge calls at. The rate decides the number of seconds callers get for 10p. It is first set to charge rate 100, but you can choose any rate from 20 to 500. The table on the right shows how many seconds callers will get for 10p at some example charge rates.

① Start programming, if you haven't already

2 Press \*24#

*The display will show the current charge rate.*

*To change the charge rate, you can*

– increase the charge rate by pressing

**Memory 3**

– decrease the charge rate by pressing

**Memory 4**

– enter a charge rate using the number keys.

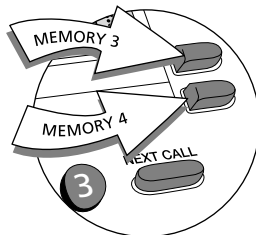

3 Press #

*The display will flash once to confirm the setting.*

4 Write the new charges on your payphone notice

5 Program another feature or lock the programming lock, remove the key and replace the handset.

Type of call		Number of seconds callers get for 10p at some example charge rates			
Band	Rate	75	100	150	200
Local	Daytime	73.3	55.0	36.7	27.5
	Cheap	73.3	55.0	36.7	27.5
	Weekend	73.3	55.0	36.7	27.5
National	Daytime	73.3	55.0	36.7	27.5
	Cheap	73.3	55.0	36.7	27.5
	Weekend	73.3	55.0	36.7	27.5
Mobile	Daytime	10.7	8.0	5.3	4.0
	Cheap	16.0	12.0	8.0	6.0
	Weekend	16.0	12.0	8.0	6.0
Premium	Daytime	8.0	6.0	4.0	3.0
	Cheap	9.3	7.0	4.7	3.5
	Weekend	9.3	7.0	4.7	3.5
Eire	Daytime	10.7	8.0	5.3	4.0
	Cheap	14.7	11.0	7.3	5.5
	Weekend	14.7	11.0	7.3	5.5
Europe	Daytime	8.0	6.0	4.0	3.0
	Cheap	8.0	6.0	4.0	3.0
	Weekend	8.0	6.0	4.0	3.0
America	Daytime	10.7	8.0	5.3	4.0
	Cheap	10.7	8.0	5.3	4.0
	Weekend	10.7	8.0	5.3	4.0
Asia	Daytime	8.0	6.0	4.0	3.0
	Cheap	8.0	6.0	4.0	3.0
	Weekend	8.0	6.0	4.0	3.0
World	Daytime	2.7	2.0	1.3	1.0
	Cheap	2.7	2.0	1.3	1.0
	Weekend	2.7	2.0	1.3	1.0

① Start programming

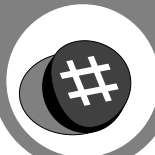



## Setting the minimum fee

You can choose how much callers will need to put into the payphone to start their call. The minimum fee will automatically adjust to reflect the time and day of the call, and the distance of the call.

---

① Start programming, if you haven't already

---

2 Press \*64#

*The display will show the current minimum fee.*

---

3 To change the minimum fee, you can

- increase the fee by pressing **Memory 3**
- decrease the fee by pressing **Memory 4**.

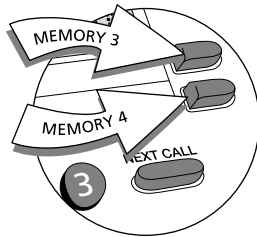

---

4 Press ##

*The display will flash once to confirm the minimum fee is set.*

---

5 Program another feature or lock the programming lock, remove the key and replace the handset.

## Programming new coins or tokens

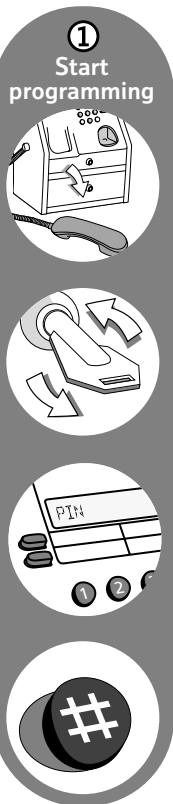

You can program your payphone to recognise and accept new coins or tokens. For example, if you want the payphone to accept tokens from a games machine, you can decide how much they will be worth and the payphone will accept them. The instructions below will ask you to insert eight of the new coins or tokens. It is better to use eight different ones rather than the same one eight times, so that the payphone recognises the slight differences in the coins or tokens.

If the new coin or token is too similar to an existing coin, the payphone will not be able to accept it.

① Start programming, if you haven't already

2 Press \*86#

The display will show **TOKEN R 1**

3 Insert the first coin or token

The display will show **TOKEN R 2**

4 Continue to insert coins or tokens until the display shows **TOKEN R £0.00**

If the display shows **ERROR**

*the new coin or token is too similar to an existing coin and can't be used.*

5 To set the value of the coin or token, you can

- increase the value by pressing **Memory 3**
- decrease the value by pressing **Memory 4**
- enter a value using the number keys.

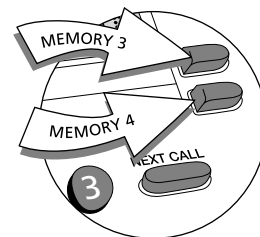

6 Press #

*If you would like to program another coin or token, repeat steps 3 to 6.*

7 Program another feature or lock the programming lock, remove the key and replace the handset.

## Programming exception codes

Your payphone uses the first few digits of any number dialled to determine the charge rate for the call. You can program exceptions to the normal settings. For instance, you could set a certain rate for international calls.

① Start programming, if you haven't already

2 Press \*39#

The display will show -----

If you have previously entered exception codes, press **Memory 3** or **Memory 4** to move through the list.

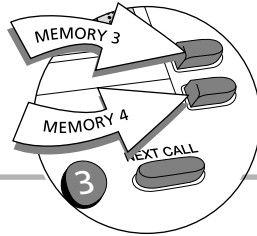

3 Enter the number

You can enter up to 6 digits.

4 Press #

The display will show BARRED

5 Press **Memory 1** to move through the different call charge types

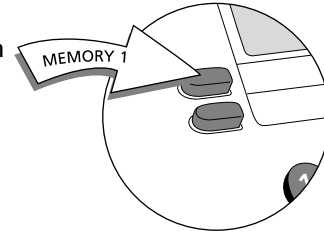

The different call charge types are: BARRED, FREE, FEE £0.50, DIR ENQ, WORLD, ASIA, AMERICA, EUROPE, EIRE, PREMIUM, MOBILE, NATIONAL AND LOCAL.

If you want to charge a fixed fee for a type of call, regardless of the length, go to FEE £0.50 and use **Memory 3** to increase the value or **Memory 4** to decrease the value. If you choose this option, the caller will only have to put in the fixed fee – the payphone will not ask for more money no matter how long the call is.

6 Press #

The display will show -----

If you would like to program another exception code, repeat steps 3 to 6.

7 Program another feature or lock the programming lock, remove the key and replace the handset.

1  
Start programming

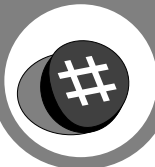
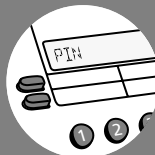

## Cancelling exception codes

You can cancel any of the exception codes you have previously set.

1 Start programming, if you haven't already

2 Press \*39#

The display will show any exception codes you have previously set.

Press **Memory 3** to scroll up through them and **Memory 4** to scroll down through them.

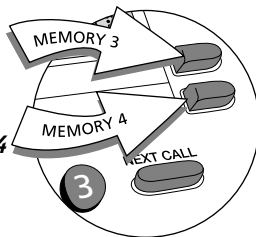

3 Press **REDIAL** when you come to the exception code you want to cancel

4 Press #

The display will flash once to confirm the code is cancelled.

5 Program another feature or lock the programming lock, remove the key and replace the handset.

## Charging for calls to Directory Enquiries

If you do not have a payphone line, you can choose to charge for calls made from your payphone to Directory Enquiries. If you don't do this, you will have to pay for the cost of any calls made to Directory Enquiries.

1 Start programming, if you haven't already

2 Press \*37#

The display will show **FEE £0.00**

3 To set the fee for a call to Directory Enquiries, you can

- increase the fee by pressing **Memory 3**
- decrease the fee by pressing **Memory 4**

You may want to charge around 50p for a call to Directory Enquiries.

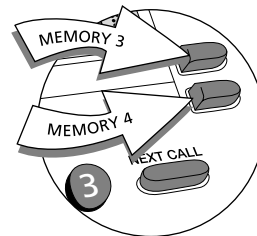

4 Press #

The display will flash once to confirm the fee is set.

5 Program another feature or lock the programming lock, remove the key and replace the handset.

## Setting the payment timer

You can adjust the length of time callers have to put money in before the payphone disconnects them. The factory setting is 39 seconds after you have finished dialling.

① Start programming, if you haven't already

2 Press \*78#

The display will show  
to show the factory  
setting of 39 seconds.

TIMEOUT 39

3 To change the length of time, you can

- increase the time by pressing **Memory 3**
- decrease the time by pressing **Memory 4**
- enter a time using the number keys.

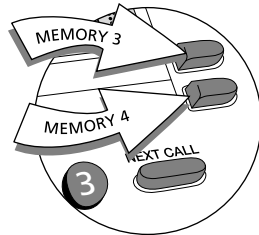

4 Press #

The display will flash once to confirm the length of time has been set.

5 Program another feature or lock the programming lock, remove the key and replace the handset.

## Programming the Memory buttons

### 1 Start programming

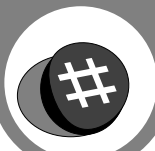

You can program up to four memory numbers, such as a local taxi firm, into the payphone. The caller just has to press a **memory button** to dial the number.

1 Start programming, if you haven't already

2 Press \*63#

The display will show **ENTER TEL**

3 Enter the phone number you want to program

You can enter up to 22 digits. If you make a mistake, press **REDIAL #** and start again. If callers need to dial a code for an outside line, remember to include the code for an outside line before the number you program.

4 Press the **Memory button** you want to program the number into

The display will show the type of call band the payphone will use for calls to this number, for instance. **LOCAL**

5 Press **Memory 2** to change the call band, and keep pressing it to scroll through the choices - it doesn't matter if you have programmed a phone number into the **Memory 2** button, you can still use it to select a call band

To set a fixed fee, press **Memory 2** until the display shows **FEE £0.50** and use **Memory 3** to increase the value or **Memory 4** to decrease the value. If you choose this option, the caller will only have to put in the fixed fee – the payphone will not ask for more money, no matter how long the call is.

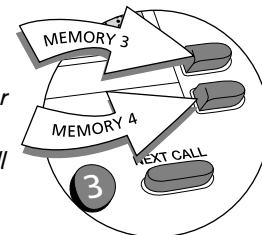
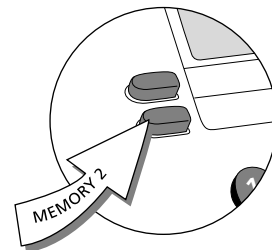

6 Press #

The display will show **ENTER TEL**

- 
- 7** Repeat steps 3 to 6 until you have programmed all the **Memory buttons** you want

*If you want to offer callers a choice of display languages, don't program a phone number into **Memory 4**.*

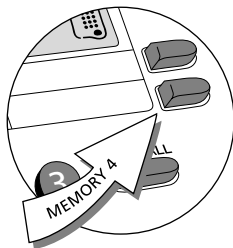

- 
- 8** Unlock the cash box lock and lift up the cash box cover

- 
- 9** Push the display release lever to release the display cover

*The lever is under the sticker marked **DISPLAY RELEASE**. Press the part of the lever under the **D** of the sticker – you will need to press quite hard. The front of the display cover will come out slightly. It is best to slide something flat under this corner and gently lever the display cover out.*

- 
- 10** Write the name of the business or service in the space on the card

- 
- 11** Replace the card and press the display cover into place until it clicks

- 
- 12** Program another feature or lock the programming lock, remove the key and replace the handset.

## Setting the time and day

### 1 Start programming

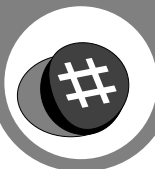

Your payphone uses the time and the day to set call charges, so it is important that it is set correctly. You will need to change the time on your payphone when the clocks go forward in spring and back in autumn.

1 Start programming, if you haven't already

2 Press \*84#

The display will show **TIME** and the current time

3 Check the time is correct (the payphone uses the 24 hour clock). To change the time, you can

- move the time forward by pressing **Memory 3**
- move the time backward by pressing **Memory 4**
- enter the current time using the number keys.

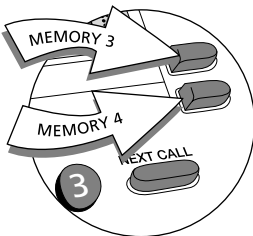

4 Press #

5 Press \*32#

The display will show the current day.

6 Check the day is correct. To change the day, you can

- move the day forward by pressing **Memory 3**
- move the day backward by pressing **Memory 4**.

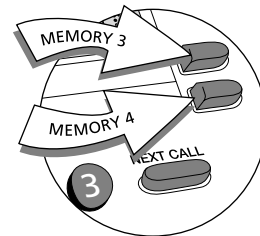

7 Press #

8 Program another feature or lock the programming lock, remove the key and replace the handset.



## Using different display languages

You can set up your payphone so callers will be able to choose to see the display messages in English, French, German, Italian, Spanish or Welsh.

If you choose this option, you will not be able to program a phone number into the **Memory 4** button.

① Start programming, if you haven't already

2 Press \*52#

The display will show LANGUAGE ✓

if the languages are on

or

LANGUAGE x

if the languages are off.

3 Press **Memory 3** to change the setting

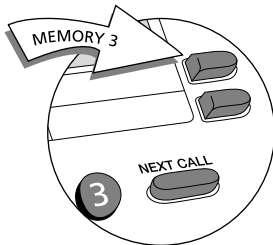

4 Press #

The display will flash once to confirm your choice.

5 Lift the cover

6 Push the display release lever to release the display cover

The lever is under the sticker marked **DISPLAY RELEASE**. Press the part of the lever under the **D** of the sticker – you will need to press quite hard. The front of the display cover will come out slightly. It is best to slide something flat under this corner and gently lever the display cover out.

7 Turn the card round so the section with the flags will be next to **Memory 4**

Remember to write any memory numbers you have programmed into the other 3 spaces.

8 Replace the display cover and press until it clicks into place

9 Program another feature or lock the programming lock, remove the key and replace the handset.

## Changing your PIN

### 1 Start programming

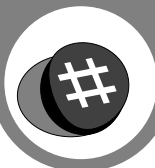

You can change your PIN to one that's easier to remember. Remember to change your PIN straight away if you think someone might have found out what it is. You will need your old PIN to enter the programming mode, so if you have forgotten it or can't find it, contact the Helpdesk. For contact details, see page 2.

### 1 Start programming, if you haven't already

2 Press \*74#

The display will show SET TO ----

### 3 Enter your new PIN

If you make a mistake, finish entering a number then enter your new PIN again.

4 Press #

The display will flash once to confirm your new PIN is set.

5 Program another feature or lock the programming lock, remove the key and replace the handset.

## Setting the dialling mode

The normal setting is TouchTone™ dialling. If the dialling tone doesn't stop when you dial a number, switch to Pulse dialling and try again.

### 1 Start programming, if you haven't already

2 Press \*34#

The display will show the current dialling mode.

3 Press Memory 3 to change the dialling mode

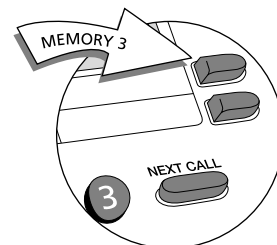

4 Press #

The display will flash once to confirm the dialling mode is set.

5 Program another feature or lock the programming lock, remove the key and replace the handset.

# Troubleshooting

Use this section to help you try to solve any problems you may have with your payphone.

If	you should
there is no dialling tone	<p>try resetting your payphone:</p> <ol style="list-style-type: none"><li data-bbox="600 376 820 404">1 Lift the handset</li><li data-bbox="600 407 1110 435">2 Unlock the cash box lock and lift the cover</li><li data-bbox="600 439 887 467">3 Press the reset button <i>The button is just above the hinge and is marked by a label. You will need a matchstick or a similar object to press it.</i></li><li data-bbox="600 537 1059 565">4 Close the cover and lock the cash box</li><li data-bbox="600 568 871 596">5 Replace the handset</li><li data-bbox="600 600 1273 669">6 Check the payphone still shows the correct time and day – see page 32.</li></ol>
your payphone does not ring	<p>check:</p> <ul style="list-style-type: none"><li data-bbox="600 725 1094 753">■ that the ringer switch is on – see page 15</li><li data-bbox="600 757 1083 785">■ that you have not barred incoming calls</li><li data-bbox="600 788 1305 816">■ that you don't have too many phones connected to the line</li></ul>
there is nothing on the display	<p>try resetting your payphone – see instructions above.</p>

# Troubleshooting

## If

## you should

the display shows 'PIN'

check you have locked the programming lock and removed the key.

the display shows 'EMERGENCY'

check:

- that the cash box is not full
- that the coin slot is not jammed.

a coin has become jammed

try sharply tapping the side of the payphone, or gently shaking it. Once you have dislodged the coin, you will have to reset your payphone – *see page 35*.

the display shows 'BARRED'

check that the payphone allows the type of calls you are trying to make – *see page 12*. If the payphone is programmed correctly but still shows BARRED, contact the Helpdesk. For contact details, see page 2.

the payphone won't take coins

check:

- that the cash box is not full
- that the coin slot is not jammed

If this doesn't work, try resetting your payphone – *see page 35*.

**If**

**you should**

you forget your new PIN

contact the Helpdesk.

you forget the payphone's original PIN

contact the Helpdesk.

you lose the cash box keys

call **X2Connect Ltd** on 0800 373 085. You will need the key number or the serial number of your payphone. These numbers should be written on page 2. If you did not write the numbers down, you will find the serial number on the bottom of the payphone. There is a charge for replacing cash box keys.

the dialling tone won't go away

try setting the dialling mode to the other option (pulse or tone) – *see page 34*. If you find that you have to set it to pulse to make the dialling tone go away when you are dialling, contact the Helpdesk. For contact details, see page 2.

you get a message when you are dialling saying 'This service is not available. Please contact BT.'

check whether you have programmed your payphone to withhold your phone number – *see page 17*. If you have a payphone line, this service is not available and should be switched off.

the previous solutions don't work

try resetting your payphone – *see page 35*.

*you have a problem not covered in this section*

*please contact us the Helpdesk – for contact details, see page 2*

# Technical

## Protecting against vandalism and theft

Your Payphone Contour 200 is designed for use in constantly supervised and sheltered sites. It is not recommended for locations where there is any risk of vandalism or theft.

## Connecting to the BT Network

The Payphone Contour 200 is approved:

- to provide a public payphone service
- for multi-frequency (tone) and loop disconnect (pulse) dialling
- for inductive coupling to appropriate hearing aids
- for call barring
- for use with compatible:
  - PBXs
  - PABXs
  - key systems
  - dealerboards
  - key and lamp units
  - automatic call distributors which provide a BS6312 compatible port and meet the requirements for simple phones. Your supplier will be able to provide you with a list of compatible apparatus.

## Maintaining your Payphone Contour 200

Keep the Payphone clean and make sure that the coin slots are always free of obstructions.

Do not polish the keypad.

## Requirements for payphone notices

OFTEL Regulations require you to display a payphone notice which gives the following information:

- details of limitations of access to the 100 Operator service
- what happens to unused coins
- the minimum payment to make a call
- the method of payment
- the full postal address of the location of the payphone
- the person who should be contacted about caller complaints
- how calls are charged
- an indication that 999 and 112 calls are free
- a warning that calls may be overheard where other extensions are connected to the same line.

## VAT liability

If you are registered for VAT, you will be required by HM Customs and Excise to account for the VAT on the cash you collect in your Payphone Contour 200.

## Liability for calls

You must pay all the BT call charges. Calls are charged at standard BT rates.

You can set the rate that you charge for calls made from your Payphone Contour 200.

You might want to use the money you collect to contribute to the call charges and rental charges.

## BT Chargecard calls

Calls made with a BT Chargecard which is charged to your Payphone Contour 200's phone number will be charged on your phone bill in the normal way. You will not be charged for calls made with other BT Chargecards.

# Index

Barring			
calls made with fake coins	13		
incoming calls	14		
outgoing calls	12		
Calls			
answering	7		
barring	12-14		
making	4		
making another call	5		
making Memory calls	5		
Owner calls	6		
redialling	5		
without coins	6		
Cash box key	2, 37		
Cash box tray			
emptying	8		
Charges			
rates	24		
setting	24		
Coins			
jammed	36		
programming new	26		
barring	16		
when to put in	4		
Day			
changing	32		
Dialling mode			
setting	34		
Dialling tone, no	35		
Directory Enquiries	28		
Display			
problems with	35		
setting languages	33		
Display cover			
removing	31		
Exception codes			
programming	27		
cancelling	28		
Helpdesk contact details	2		
Identification tone			
setting	18		
Keys			
lost	37		
Languages			
for display messages	33		
Memory buttons			
programming	30		
using	5		
Minimum fee			
setting	25		
Money			
checking	9		
resetting	9		
Next call			
making a	5		
Operator tone			
setting	19		
Owner calls	6		
PBX			
see Switchboard			
Payment timer			
setting	29		
PIN			
changing	34		
Privacy			
setting	20		
Programming	11		
Programming keys	2, 37		
Reset button	35		
Resetting	35		
Ringer switch	15		
Serial number	2		
Slugs			
barring	13		
Switchboard			
removing a code	23		
setting an automatic code	21		
setting a manual code	22		
Time			
changing	32		
Tokens			
programming new	26		
programming fake	13		
Withholding your number	17		